



Original instructions

NZ-30 SDS-Plus Multi-function Rotary Hammer Operating Manual (Professional)



» Company Profile

NENZ Electric Technology (Dong Guan) Co., Ltd which focuses on research and development of electric tools as well as sales and after-sale service of those is one of the high-tech enterprises. The company is composed of returnees who have built a powerful team with strong design and development capabilities, setting up a research and development center, manufacturing center, marketing center in the forefront of the world's most dynamic and innovative areas of Dong guan City, Guangdong Province.

The company concentrates on research and development of all kinds of its own professional-grade and industrial-grade brand of power tools, hand tools and garden tools. The main products are various DC (AC) rotary hammers, demolition hammers, polishers, sanders, drills, angle grinders, planers, circular saws, cutting saws, flashlights, chain saws, lawn mowers, etc. The company pursues innovation constantly, adhering to the developmental concept "superb technology, quality service and excellence", which always sticks to the business philosophy "serving for customers and creating greater value for customers". It constantly improves and enhances product quality and service quality. Our products are widely used in building decorations, common decorations, high-speed rail construction, shipbuilding industry, water conservancy industry etc.. To ensure world-class quality products, the company has introduced all kinds of internationally advanced detection equipment, and strives to building the testing center of domestic leading level.

NENZ — CREATE THE FUTURE!



- 1 SDS Plus Bit (Two Pits ,Two Groove and Round Handle) 2 Dust Shield 3 Depth Gauge Rod
 4 Button of Depth Gauge 5 Mode Selector Knob 6 Control-Vibration System 7 Trigger
 8 Plastic Handle Cover 9 Cord Strain Relief 10 Power Cord 11 Brush Cap
 12 Side Handle 13 Sliding Collar

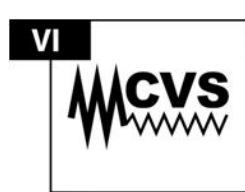
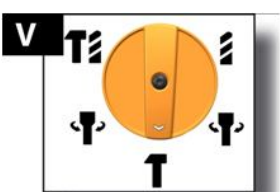
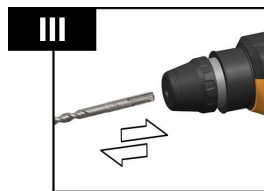



1. Joint Lever

Key Chuck

Assemble bit by key

2. Screw connects with lever



TIP

Add little grease

Quickly stick into chuck

TIP Rotate it when it is inapplicable

Installation Drawing

4.

Press chuck for pulling out bit



Side Handle and Depth Gauge Assembly

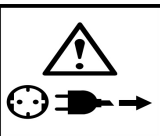

1.

3. Assemble it to the sleeve

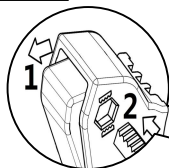

1. Press the button

4. Rotate the handle until lock in the right position

2. Stick the depth rod into auxiliary handle hole along the teeth direction



2.

Installation Drawing



3

Press the button for adjusting drill holes depth

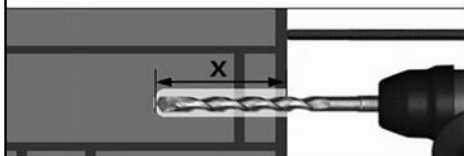
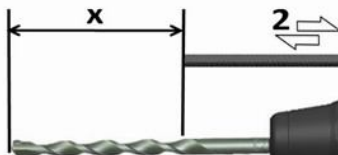

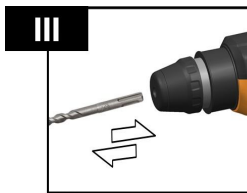

Bit Assembly

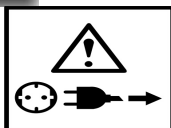

1. INSERTING

Add little grease on the nose of bit, rotate bit and stick into chuck



2. TEST

Don't pull bit out from the chuck after the bit stuck into chuck

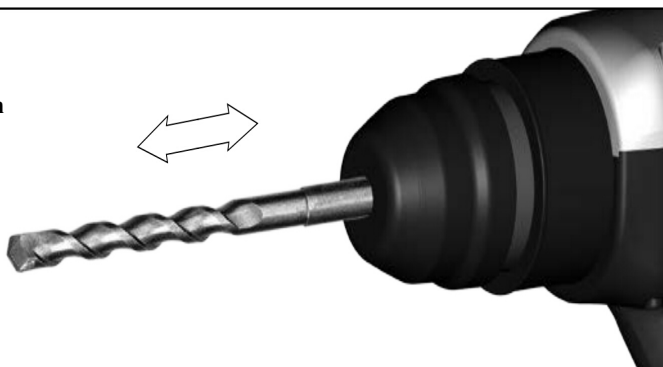
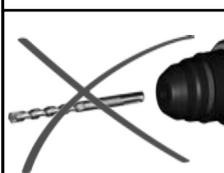

3. DISASSEMBLE

Get out the bit while pressing the chuck

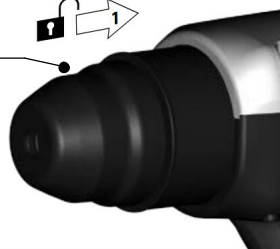
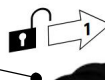

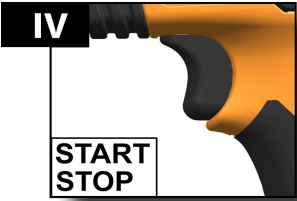

**Trigger
Operation**

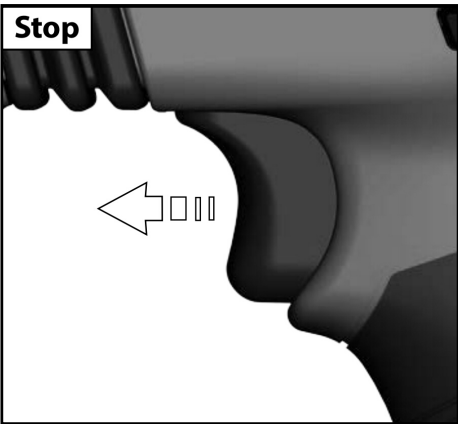
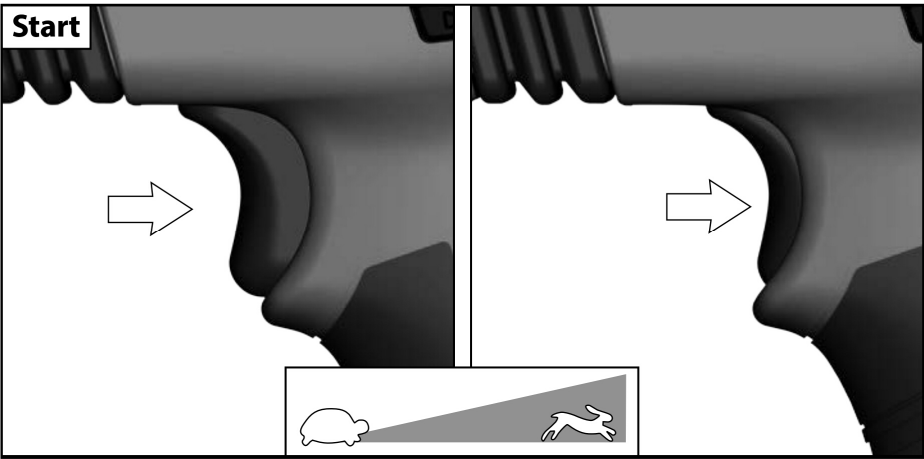

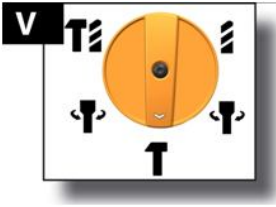

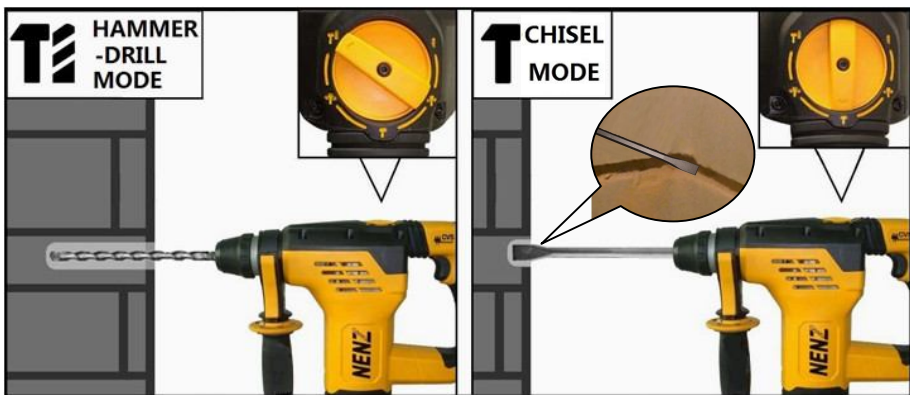

Mode Selector Knob Operation

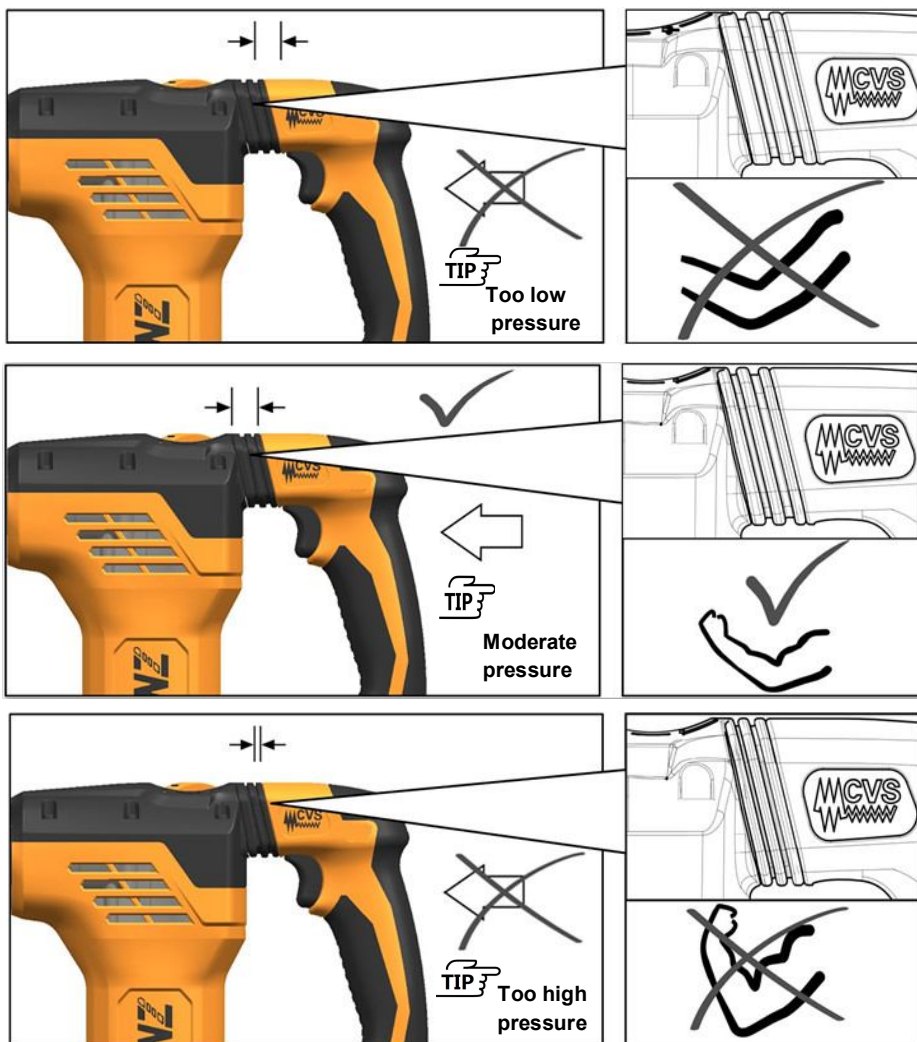

Control Vibration System

Technical Data		NZ-30	
Production Code	NZ-30		
Rated Voltage	220-230 V	V	
Rated Power	850 W	W	
No-load Speed	0-1500 Min ⁻¹	BPM	
Blows per Minute (BPM)	0-5000 Min ⁻¹	BPM	
Impact Energy per Stroke	4 J	J	
Wire Cord length	2.4m	M	
Maxium Drilling Diameter :			
- Concrete	30 mm	MM	
- Steel	13 mm	MM	
- Wood	40 mm	MM	
- Light Core Cutter in Bricks and Limestone	82 mm	MM	
Chuck Neck Diameter	54 mm	mm	
Tool Chuck	SDS Plus		
Weight Acording to EPTA-Produce 01/2009	3 Kg	Kg	
Insulation Class	 / II	 / II	
Trigger	●		
Safety Clutch	●		
Accessories			
Drill Chuck	Optional		
Drill Bit	SDS-Plus		
Auxiliary Handle	●		
Depth rod	●		
Packing			
BMC	1		
Instruction Manual	1		

General Power Tool Safety Warnings



WARNING!

Read all safety warnings and all instructions. Failure to follow the warnings and instructions may result in electric shock, fire and/or serious injury.

Save all warnings and instructions for future reference.

The term "power tool" in the warnings refers to your mains-operated (corded) power tool or battery-operated (cordless) power tool.

Intended use

The tool is intended for hammer drilling and drilling in brick, concrete and stone. It is also suitable for drilling hole without impact function in wood, plastic and metal. It can not be used for building site, only for domestic application.

1) Work area safety

- a) **Keep work area clean and well lit.** Cluttered or dark areas invite accidents.
- b) **Do not operate power tools in explosive atmospheres, such as in the presence of flammable liquids, gases or dust.** Power tools create sparks which may ignite the dust or fumes.
- c) **Keep children and bystanders away while operating a power tool.** Distractions can cause you to lose control.

2) Electrical safety

- a) **Power tool plugs must match the outlet. Never modify the plug in any**

way. Do not use any adapter plugs with earthed (grounded) power tools. Unmodified plugs and matching outlets will reduce risk of electric shock.

- b) **Avoid body contact with earthed or grounded surfaces, such as pipes, radiators, ranges and refrigerators.** There is an increased risk of electric shock if your body is earthed or grounded.
- c) **Do not expose power tools to rain or wet conditions.** Water entering a power tool will increase the risk of electric shock.
- d) **Do not abuse the cord. Never use the cord for carrying, pulling or unplugging the power tool. Keep cord away from heat, oil, sharp edges or moving parts.** Damaged or entangled cords increase the risk of electric shock.
- e) **When operating a power tool outdoors, use an extension cord suitable for outdoor use.** Use of a cord suitable for outdoor use reduces the risk of electric shock.
- f) **If operating a power tool in a damp location is unavoidable, use a residual current device (RCD) protected supply.** Use of an RCD reduces the risk of electric shock.

3) Personal safety

- a) **Stay alert, watch what you are doing and use common sense when operating a power tool. Do not use a power tool while you are tired or under the influence of drugs, alcohol or medication.** A moment of inattention while operating power tools may result in serious personal injury.

- b) **Use personal protective equipment. Always wear eye protection.** Protective equipment such as dust mask, non-skid safety shoes, hard hat, or hearing protection used for appropriate conditions will reduce personal injuries.
- c) **:Prevent unintentional starting. Ensure the switch is in the off-position before connecting to power source and/or battery pack, picking up or carrying the tool.** Carrying power tools with your finger on the switch or energising power tools that have the switch on invites accidents.
- d) **Remove any adjusting key or wrench before turning the power tool on.** A wrench or a key left attached to a rotating part of the power tool may result in personal injury.
- e) **Do not overreach. Keep proper footing and balance at all times.** This enables better control of the power tool in unexpected situations.
- f) **Dress properly. Do not wear loose clothing or jewellery. Keep your hair, clothing and gloves away from moving parts.** Loose clothes, jewellery or long hair can be caught in moving parts.
- g) **If devices are provided for the connection of dust extraction and collection facilities, ensure these are connected and properly used.** Use of dust collection can reduce dust-related hazards.

4) Power tool use and care

- a) **Do not force the power tool. Use the correct power tool for your application.**

The correct power tool will do the job better and safer at the rate for which it was designed.

- b) **Do not use the power tool if the switch does not turn it on and off.** Any power tool that cannot be controlled with the switch is dangerous and must be repaired.

- c) **Disconnect the plug from the power source and/or the battery pack from the power tool before making any adjustments, changing accessories, or storing power tools.** Such preventive safety measures reduce the risk of starting the power tool accidentally.

- d) **Store idle power tools out of the reach of children and do not allow persons unfamiliar with the power tool or these instructions to operate the power tool.** Power tools are dangerous in the hands of untrained users.

- e) **Maintain power tools. Check for misalignment or binding of moving parts, breakage of parts and any other condition that may affect the power tool's operation. If damaged, have the power tool repaired before use.** Many accidents are caused by poorly maintained power tools.

- f) **Keep cutting tools sharp and clean.** Properly maintained cutting tools with sharp cutting edges are less likely to bind and are easier to control.

- g) **Use the power cord, accessories and tool bits etc, in accordance with these instructions, taking into account the working conditions and**

the work to be performed. Use of the power tool for operations different from those intended could result in a hazardous situation.

5) Maintenance and Service

- a) The ventilation slots of the machine must be kept clear at all times.**
- b) Important note! If the carbon brush are worn, in addition to exchanging the brushes the tool should be sent to after-sales service,** this will ensure long service life and top performance.
- c) If the supply cord of this power tool is damaged, it must be replaced by a specially prepared cord available through the service organization.**
- d) Have your power tool serviced by a qualified repair person using only identical replacement parts.** This will ensure that the safety of the power tool is maintained.

6) Noise emission values

Detected noise emission values comply with the following directive EN60745-1 and EN60745-2-6;

Sound pressure level	dB(A)
Sound power level	dB(A)
Uncertainty	k



Wearing

Wear ear protectors. Exposure to noise can cause hearing loss!

7) Vibration emission value

Detected vibration emission values comply with the following directive EN60745-1 and EN60745-2-6.

3 Axis vibration	m/s²
Unertainty	k

Wearing

- The declared vibration total value has been measured in accordance with a standard test method and may be used for comparing one tool with another;
- The declared vibration total value may also be used in a preliminary assessment of exposure.
- The vibration emission during actual use of the power tool can differ from the declared total value depending on the ways in which the tool is used; and of the need to identify safety measures to protect the operate that are based on an estimation of exposure in the actual conditions of use (taking account of all parts of the operating cycle such as the times when the tool is switched off and when it is running idle in addition to the trigger time) .



Hammer safety warnings

- a) Use auxiliary handle(s), if supplied with the tool. Loss of control can cause personal injury.
- b) Hold power tool by insulated gripping surfaces, when performing an operation where the cutting accessory may contact hidden wiring or its own cord. Cutting accessory contacting a "live" wire may make exposed metal parts of the power tool "live" and could give the operator an electric shock.

INTERPRETATION OF SYMBOLS



Caution! Warning! Danger!



Read operation's manual



Pull your plug out of socket



Double Insulated



Control Vibration System



SDS-Plus



Do not dispose of electric tools together with household material in observance of European Directive 2002/96/EC on waste electrical and electronic equipment and its implementation. Please confirm with your local laws.



Accessory- Not included in standard equipment, available as an accessory.



European Conformity Mark



Chinese Conformity Mark

We declare under our sole responsibility that the products described under “Technical Data” fulfill all the relevant regulations and the directives **2014/30/EU**, 2004/108/EC, 2006/42/EC. And our products conform to the following harmonized standards:

EN 60745-1:2009 + A11:2010

EN 60745-2-6:2010

EN 55014-1:2006 + A1:2009 + A2:2011

EN 55014-2:1997 + A1:2001 + A2:2008

EN 61000-3-2:2014

EN 61000-3-3:2013

Donnie



Wechat

<http://www.nenztool.com>



Mobile Website

<http://www.nenztool.com>

Hongkong NENZ Techonology Industrial Co., Ltd.

NENZ Technology(Dongguan)Co., Ltd

**Address : NO.1 Caotang Industrial Zone,Nancheng
District, Dongguan City, Guangdong Province, China**

Tel : 0769 - 23192489

Fax : 0769 - 22821610

E-mail : sales@nenztool.com

Website : www.nenztool.com